

TL12H

series



Product Segments

- **Ergo Motion**

TiMOTION's TL12H is one of the heavy-duty lifting columns of our Ergo Motion product line. With a 3-stage, upside-down rectangular profile, each TL12H elevates up to 120kg in a smooth and steady movement. This lifting column is suitable for consoles, workbenches, industrial workstations, heavy table tops, and other heavy loading applications. It is also compatible with the control box for our Ergo Motion and TEK series.

Features

- Load and speed per column¹²

Code	Load (N)	Self Locking Force (N)	Current (A) with 24V DC		Speed (mm/s) with 24V DC	
			No Load	With Load	No Load	With Load
E	1200	1200	2.5	6.0	19.0	15.0

- Retracted length 590mm
700mm (XL)
- Stroke 650mm
950mm (XL)
- Outer profile 80*60mm rectangular
- Stages 3-stage, upside down
- Output signals Hall sensors
- Voltage 24V DC, 24V DC (UL)
- Color³
 -  RAL9005
 -  RAL9006
 -  RAL9016
 -  RAL9022
- Product weight 8.6kg /column
- With motor house

Note

- ¹ The self locking force, current, and speed performance are tested with TiMOTION control boxes.
- ² The parameters are based on average test values; final specifications are subject to the approval drawings.
- ³ For more color options, please consult your sales representative.

Performance Data with Control Box

The following is the performance data of two columns driven by an Ergo Motion control box TC15P. The load is evenly distributed on the work surface.⁴

- TL12H, two columns driven by TC15P

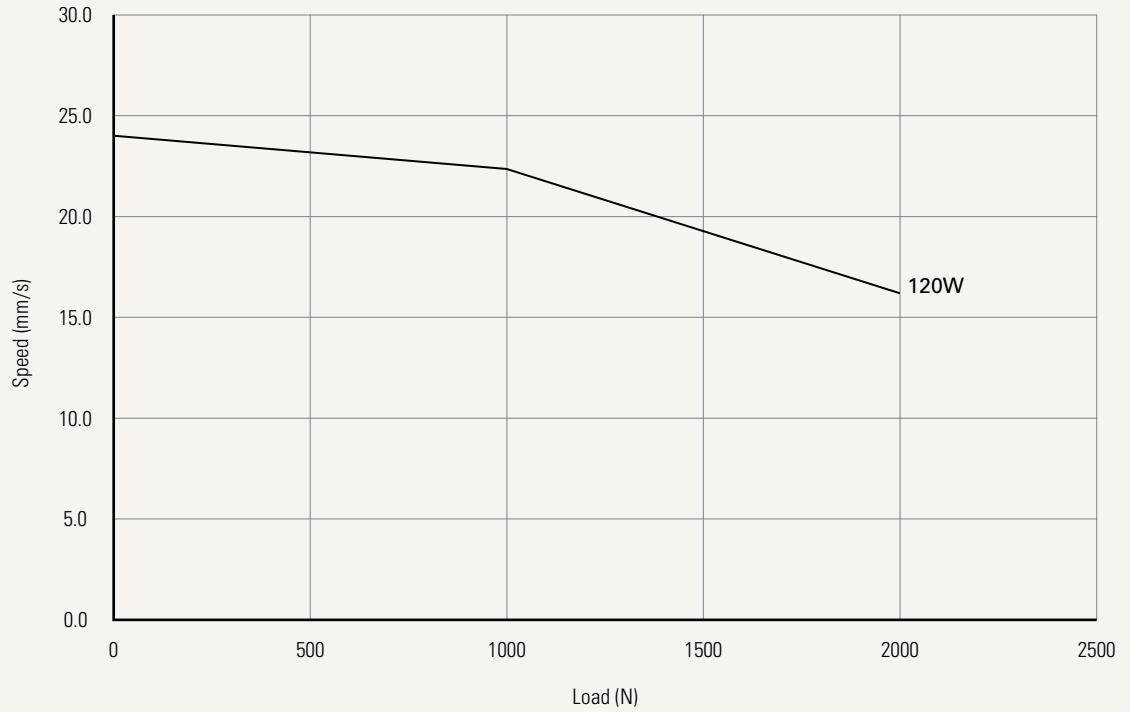

TC15P Spec	Load (N)	Constant Speed (mm/s) with TC15P
120W	2000	22.36

Note

⁴ The corresponding control box software is required.

Drawing

Standard Dimensions
(mm)

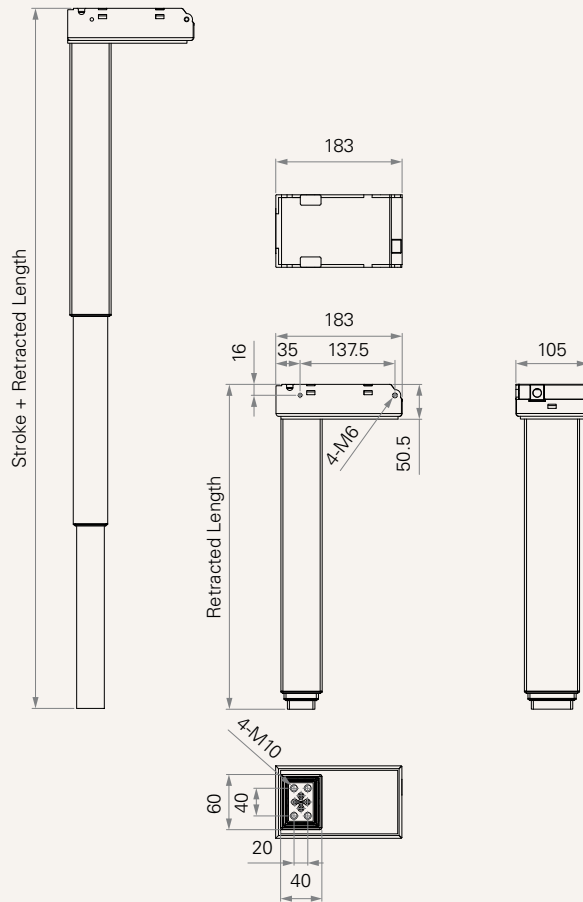

Stroke & Retracted Length

	Options	Stroke (mm)	Retracted Length (mm)
Standard Outer Tube	Standard	650	590
	M	660	560
	S	660	520
	XL	950	700
Extended Outer Tube	Standard	650	610
	M	660	580
	S	660	540
	XL	950	720

Note

- 1 Only specific TEK could be with the shoes, please refer to TEK speccode.
- 2 Reverse structure with shoe need to raise new function proposal.

Appearance of Motor House See page 6	C = TiMOTION standard			
Voltage	2 = 24V DC			
Load and Speed	See page 2			
Stroke & Retracted Length (mm)	See page 4			
Color	1 = Black, RAL 9005	2 = White, RAL 9016	3 = Grey, RAL 9006	4 = Special grey, RAL 9022
Wiper Color	1 = Black	2 = White	3 = Grey	4 = Matte black
Bracket	0 = Without			
Bottom Plate Type (mm) See page 6	1 = M10, 40*20, TiMOTION standard			
Bottom Plate Height	1 = Standard, 3mm		2 = Extended outer tube for shoe	
Output Signals	2 = Hall sensor * 2			
Connector	1 = DIN 6P, 90° plug E = Molex 8P, 180° plug, standard		F = Molex 8P, 90° plug, without anti-clip, for TC22/TC23	
Cable Length (mm)	1 = Straight, 500	3 = Straight, 1000	4 = Straight, 1500	

Note

1 The TL is designed especially for push applications, not suitable for pull applications.

Appearance of Motor House (mm)

C = TiMOTION standard

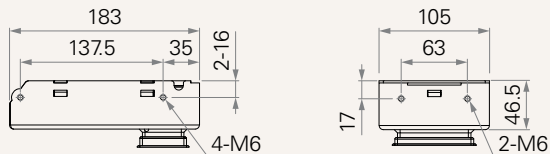

Bottom Plate Type (mm)

1 = M10, 40*20, TiMOTION standard

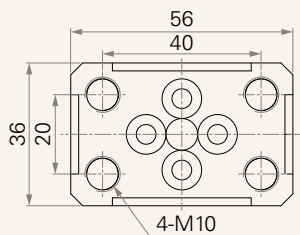

Package

Package of one TL part number

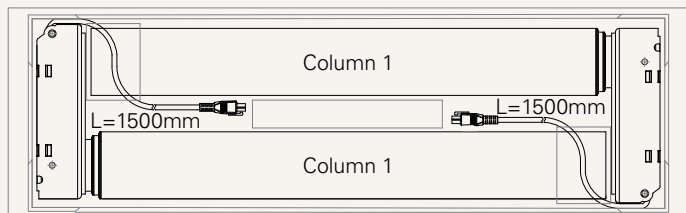

Column: 2pcs TL/box (Same PN& cable length)
 Electronic control system: Without
 Weight with package: 19KG

Package of two TL part numbers in pairs

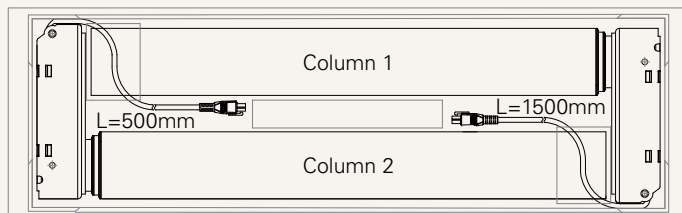

Column: 2pcs TL/box (Different PN, cable length, for pair use)
 Electronic control system: Without
 Weight with package: 19KG

Package of MP part number set-TL in pairs + electronic control system

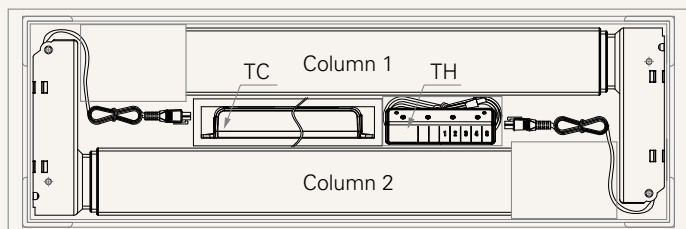

Column: 2pcs TL/box (Different PN, cable length, for pair use)
 Electronic control system: TC + TH
 Weight with package: 20KG

Terms of Use

The user is responsible for determining the suitability of TiMOTION products for a specific application. TiMOTION products are subject to change without prior notice.