

# TH14

series



---

## Product Segments

- **Ergo Motion**

---

## General Features

Maximum available buttons	2
Color	Black or grey
Direct cut support	Available
Operational temperature range	+5°C~+45°C
Simple control for height-adjustable desks	
Mounted to the desk front side	

## Drawing

Standard Dimensions  
(mm)

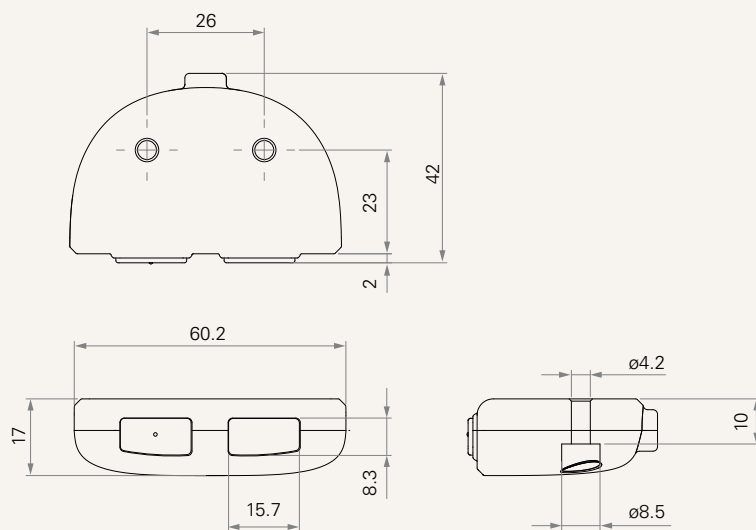

## TH14

Version: 20241129-F

Plug	1 = DIN 5P	5 = RJ 10P, 180°, for TC6 / TC9 /
	2 = DIN 8P, for TC2 / TC3 / TC7	6 = RJ 10P, 180°, for TC11 / TC15 / TC16, flat
	4 = DIN 8P, 180°, for extension cable	
Color	1 = Black	2 = Grey (Pantone 428C)
Cable Length (mm)	1 = Straight, 1000	2 = Straight, 1500

### Terms of Use

The user is responsible for determining the suitability of TiMOTION products for a specific application.  
TiMOTION products are subject to change without prior notice.